

Repair Instructions

Disc brake with oil storage

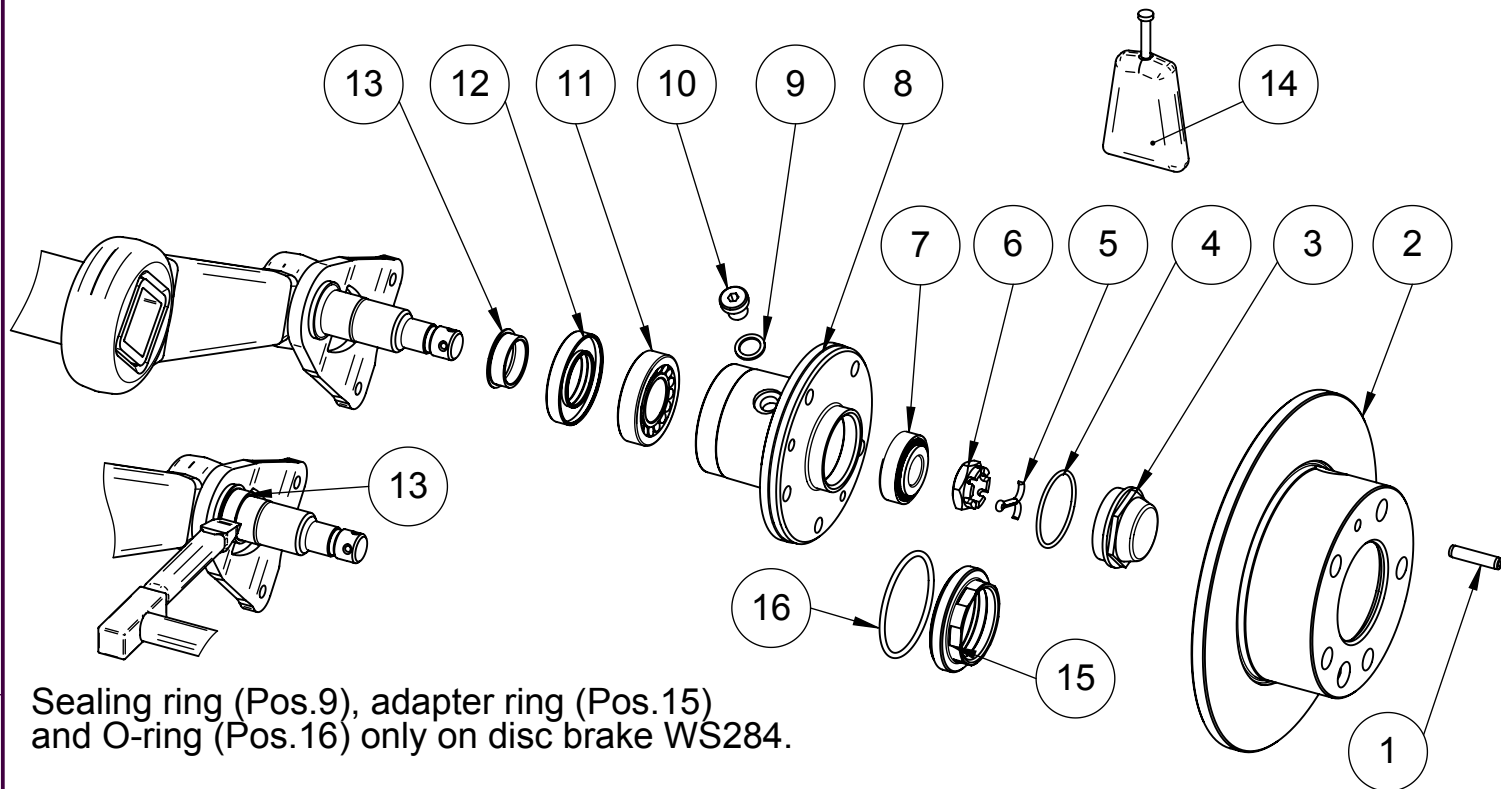

Sealing ring (Pos.9), adapter ring (Pos.15) and O-ring (Pos.16) only on disc brake WS284.

Disassemble the brake unit before dismantling.

Dismantling:

- 1.) Remove the clamping pin (Pos.1) and brake disc (Pos.2).
- 2.) Undo the sealing screw (Pos.10) and drain the bearing oil. The oil must be disposed of in accordance with legal provisions. Remove the sealing ring (Pos.9).
- 3.) Unscrew the axle cap (Pos.3) in an anti-clockwise direction and remove the O-ring (Pos.4).
- 4.) Dismantle the split pin (Pos.5) and unscrew the crown nut (Pos.6) from the thread.
- 5.) Pull the wheel hub (Pos.8) and bearing (Pos.7 and 11) off the axle stub.
- 6.) Dismantle the shaft sealing ring (Pos.12).
- 7.) Using a hammer and chisel (Pos.13), strike the adjusting ring and pull it off the axle stub.

Assembly:

- 1.) Strike the adjusting ring (Pos.13) onto the axle stub.
- 2.) Press the shaft sealing ring (Pos.12) and the bearings (Pos.7 and 11) into the bearing retainers belonging to the wheel hub (Pos.8) and assemble onto the axle stub.
- 3.) Tighten the crown nut (Pos.6) so far that the running of the wheel is decelerated slightly. Then turn the nut back to the next available split pin hole, max. 30°.
- 4.) Assemble the split pin (Pos.5).
- 5.) Insert the O-ring (Pos.4) and tighten the axle cap (Pos.3) by hand.
- 6.) Fill the bearing oil (Pos.14), insert the sealing ring (Pos.9) and tighten the sealing screw (Pos.10) by hand. The correct oil level is shown by the min. / max. display on the axle cap (Pos.3) and should ideally be between the two markings.
- 7.) Assemble the brake disc (Pos.2) with the clamping pin (Pos.1) on the wheel hub (Pos.8).

Pos.	Designation
1	Clamping pin
2	Brake disc
3	Axle cap
4	O- ring Ø48
5	Split pin
6	Crown nut
7	Bearing
8	Wheel hub
9	Sealing ring
10	Sealing screw
11	Bearing
12	Shaft sealing ring
13	Adjusting ring
14	ESSO Mobil Fluid 422
15	Adapter ring
16	O- ring Ø66

		Datum	Name
Nummer	Bearb.	09.02.2015	Schneider
MA-162_E	Prüfer	10.02.2015	Joachim

All work must be performed by specialist staff.